



Setup Corporate (Microsoft® Exchange) Email

This tutorial will walk you through the steps of setting up your corporate email account.



Microsoft Exchange Email Support



Exchange Server Information

You will need to obtain the following information:

- Server name
- Domain name
- Whether an encrypted (SSL) connection is required
- Your username and password

Please Note: Step 1 provides a way to obtain the information needed. If you're not able to obtain the information, please contact your IT administrator.

Step 1

Getting the right information



Step A – From your web browser, try to login to your Outlook Web Access (OWA).



The screenshot shows a Windows Internet Explorer browser window. The title bar reads "Outlook Web Access - Windows Internet Explorer provided by Yahoo!". The address bar contains the URL "https://mail.companydomain.com/owa/".

In the above example, the **server name** is the part of the URL between https:// and /owa/. The 's' in https means **SSL** is enabled on the server (if SSL was disabled on the server, it would just be http.) The **password** you used to log into OWA is the password you will enter on your handheld. Therefore, the Exchange Server settings would be:

- Server name** – mail.companydomain.com
(can vary according to IT setup)
- Use SSL**- Yes
- Password** – The password you entered above

Step 1 (continued)

Getting the right information



Step B – From your computer keyboard, press Ctrl-Alt-Delete, and note the logon information.

Please Note: If the steps above do not work you will have to contact your IT administrator.



The domain and user name will appear under the Logon Information. It should appear as the following:
“You are logged in as DOMAIN NAME\USER NAME”

Step 2

Setting up your phone



From the Applications Menu,
Touch Email.

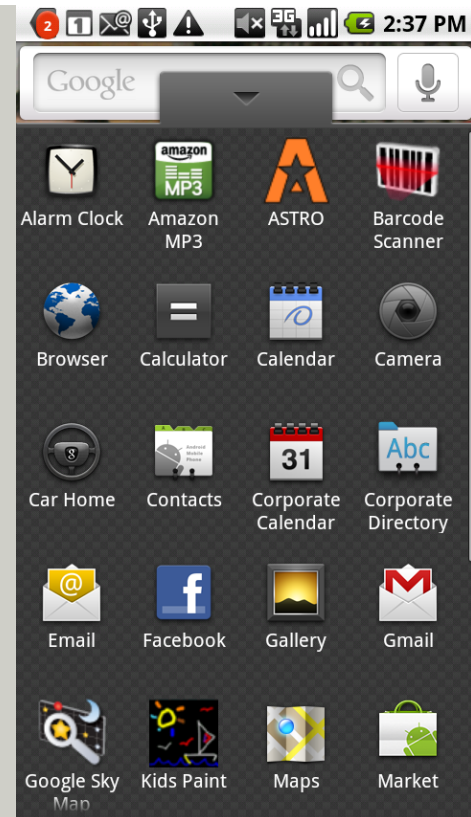

Microsoft® Exchange Email Support, Rev A

Add additional legal text here if required by your local Legal Counsel. MOTOROLA and the Stylized M Logo are registered in the US Patent & Trademark Office. All other product or service names are the property of their respective owners. © 2009 Motorola, Inc. All rights reserved.

Step 3

Setting up your phone



Type in the email address you would like to be displayed in outgoing mail, and the password.

Check the box only if you want this to be your default email account.

Touch Next.

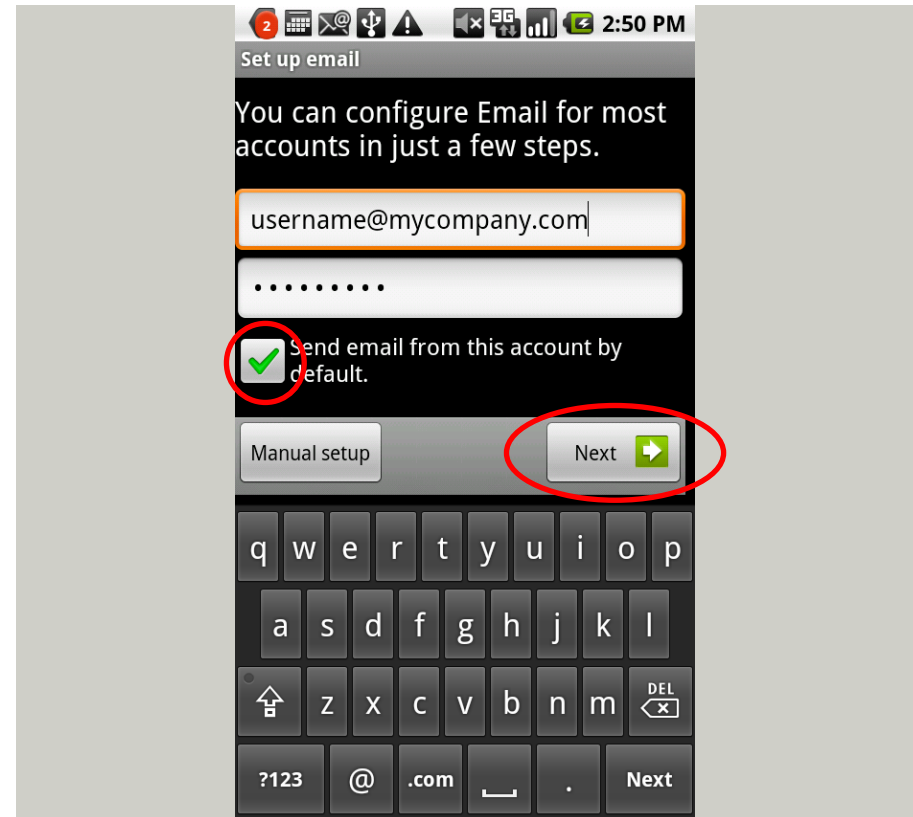

Step 4

Setting up your phone



Touch Exchange Account.

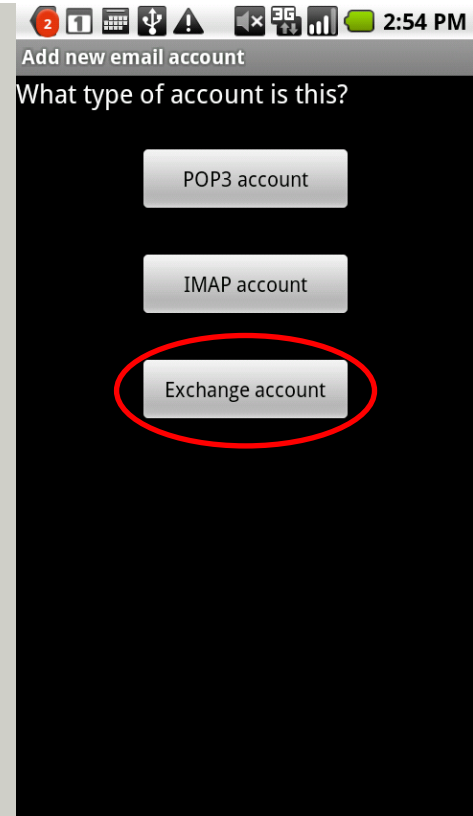

Microsoft® Exchange Email Support, Rev A

Add additional legal text here if required by your local Legal Counsel. MOTOROLA and the Stylized M Logo are registered in the US Patent & Trademark Office. All other product or service names are the property of their respective owners. © 2009 Motorola, Inc. All rights reserved.

Step 5

Setting up your phone



Enter the information you found in Step 1, and Press Next.

Tip: Do not select Accept all SSL certificates unless instructed by your IT admin.

A screenshot of a mobile device screen showing the 'Exchange server settings' configuration page. The screen has a black background with white text and input fields. At the top, there is a status bar with various icons and the time '10:22 AM'. Below the title, there are three input fields: 'Domain\Username' containing 'domain\username', 'Password' with masked dots, and 'Exchange Server' containing 'mail.companydomain.com'. Below these fields are two checkboxes: 'Use secure connection (SSL)' which is checked with a green checkmark, and 'Accept all SSL certificates' which is unchecked. At the bottom right, there is a 'Next' button with a green arrow icon.

Step 6

Setting up your phone



Your phone will check the incoming server settings.

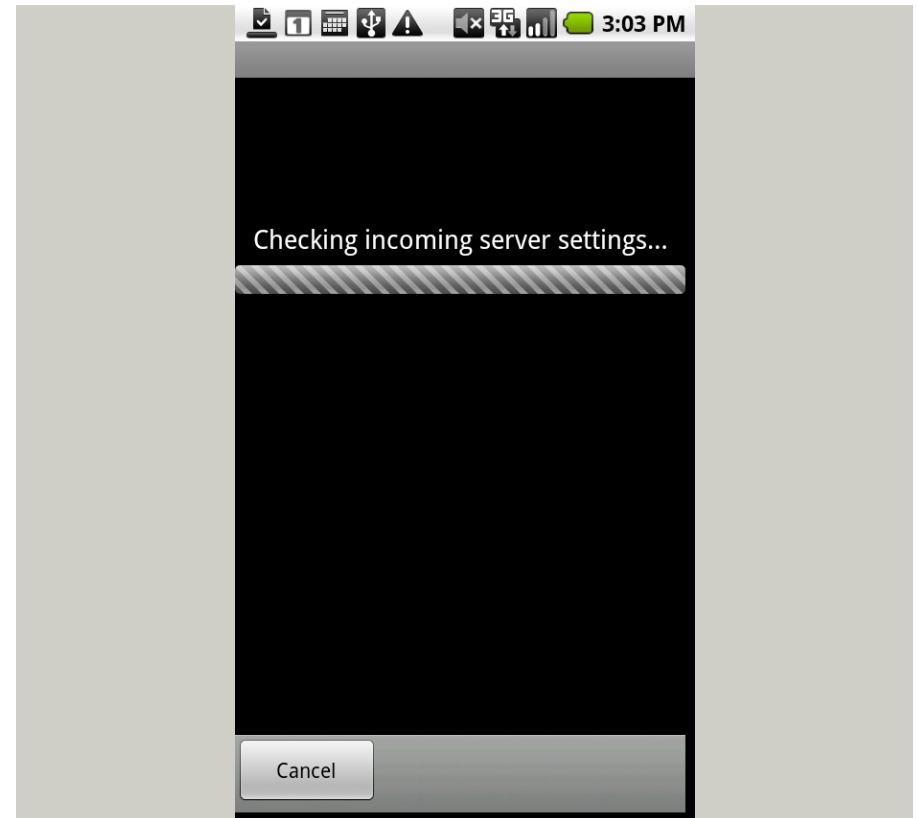

Microsoft® Exchange Email Support, Rev A

Add additional legal text here if required by your local Legal Counsel. MOTOROLA and the Stylized M Logo are registered in the US Patent & Trademark Office. All other product or service names are the property of their respective owners. © 2009 Motorola, Inc. All rights reserved.

Step 7

Setting up your phone



If everything is correct the following screen will appear allowing you to customize your account settings.

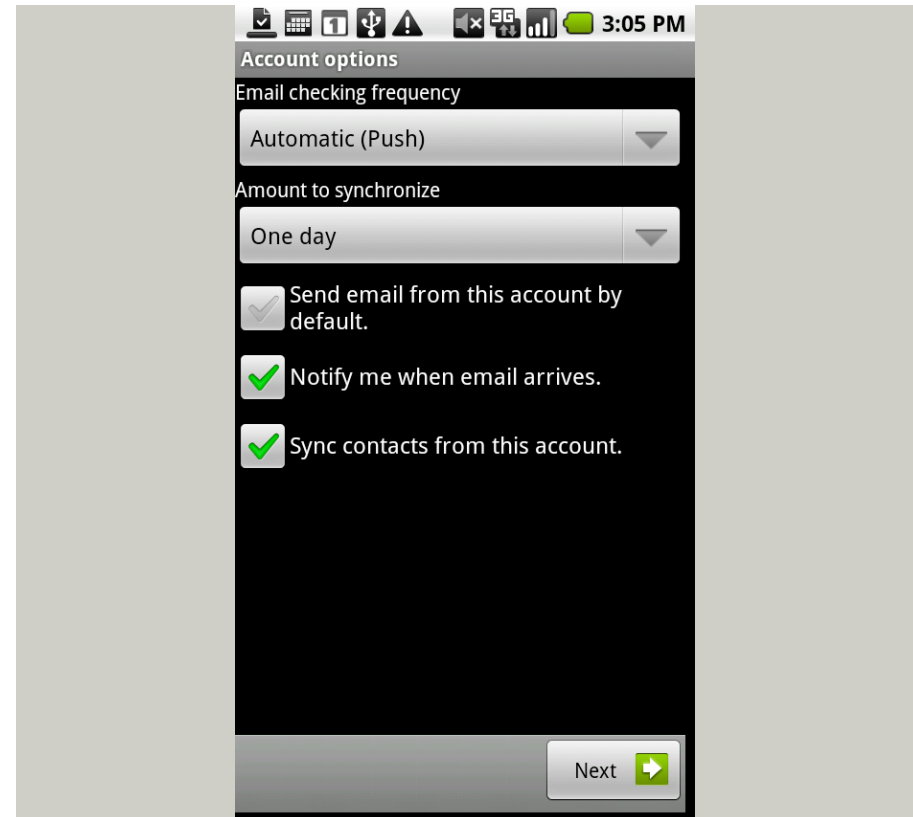

Step 8

Setting up your phone



Finally, you will be asked to name this account, and enter the name that will be displayed on outgoing messages.

Touch Done when complete.

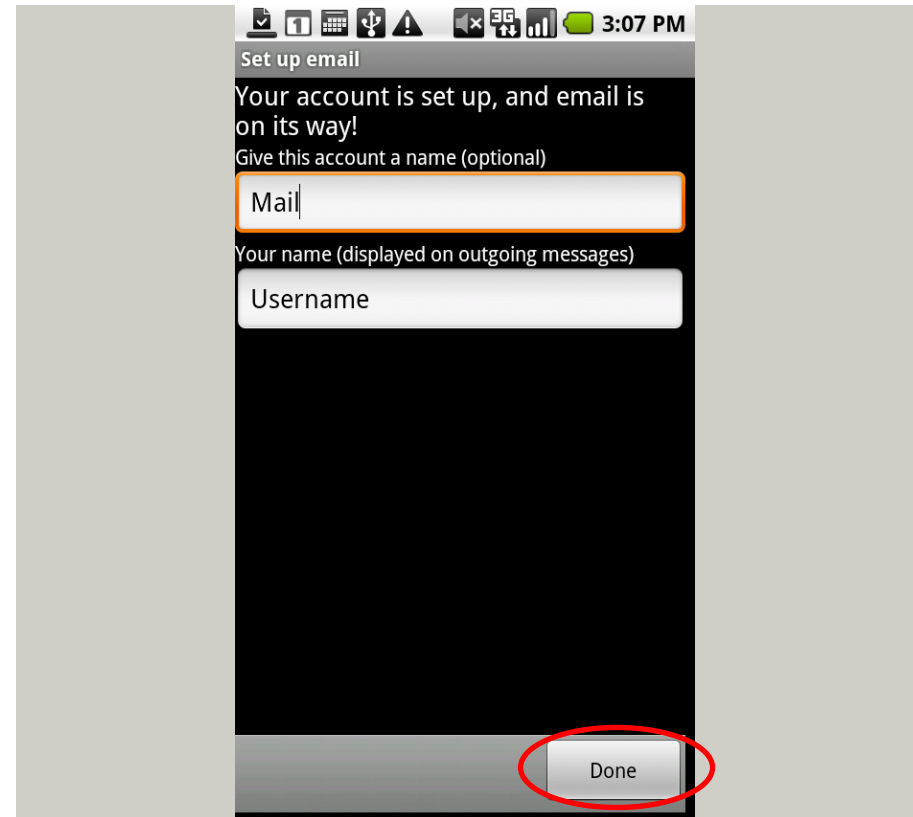

Troubleshooting



Please visit the [Microsoft Exchange Email](#) Troubleshooting FAQ if the steps above did not work.



Microsoft® Exchange Email Support, Rev A

Add additional legal text here if required by your local Legal Counsel. MOTOROLA and the Stylized M Logo are registered in the US Patent & Trademark Office. All other product or service names are the property of their respective owners. © 2009 Motorola, Inc. All rights reserved.