



MOTO™ U9

Quick Start Guide

# HELLOMOTO

**Feel It, See It, Hear It!** Your MOTO™ U9 phone is made to be held, and made to be seen!

- Transfer your favorite **music** quickly and easily with Microsoft® Windows® Media Player 11. Control music playback with touch sensor keys in the external display (page 19).
- Personalize your phone with floating **animated screensavers** in the external display (page 28).
- Read and answer **text messages** in the external display (page 30).

**For more information:** To read feature instructions on your phone, press **Main Menu > Help**. To watch Web tutorials and learn more about your phone and accessories, go to [www.hellomoto.com](http://www.hellomoto.com).

**Note:** Before using the phone for the first time, review the *Important Safety and Legal Information* guide included in the box. Periodically review this information so you remember how to safely use your phone.

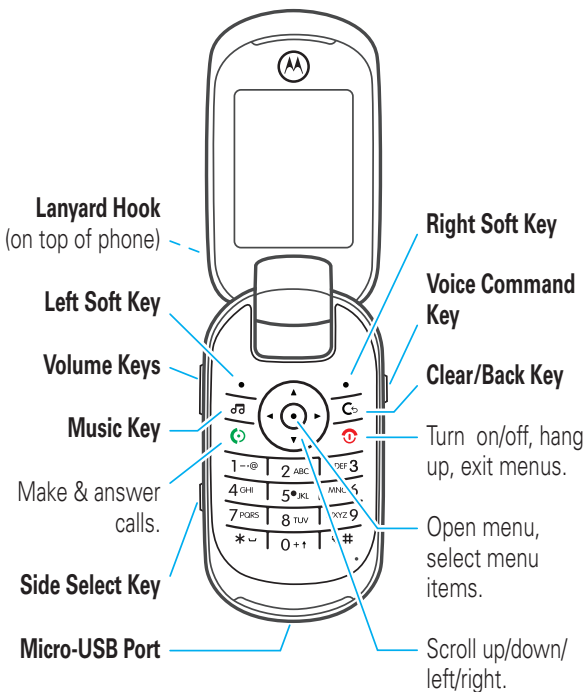

**Tip:** Press the *center key* to open the main menu and select menu options. Press the *clear/back key* to delete letters or numbers, or to go back one menu.





## contents

<b>menu map</b> .....	<b>6</b>
<b>get started</b> .....	<b>10</b>
insert your SIM card.....	10
insert a memory card.....	11
insert the battery.....	12
charge the battery.....	12
turn phone on & off.....	15
make a call.....	15
answer a call.....	15
end a call.....	15
store a phone number.....	16
call a stored phone number.....	17
your phone number.....	18
<b>music</b> .....	<b>19</b>
introduction.....	19
1. load music on your computer.....	19
2. transfer music to your phone.....	20
3. play music.....	22
use Bluetooth® stereo headphones.....	24
adjust audio settings.....	25
lock external phone keys.....	25
create a playlist.....	26
play a playlist.....	27

close the music player . . . . .	27
<b>screensavers</b> . . . . .	<b>28</b>
show animated screensavers in the external display . . . . .	28
<b>messages</b> . . . . .	<b>30</b>
read & reply to a message in the external display .	30
send a message . . . . .	31
<b>personalize</b> . . . . .	<b>32</b>
home screen shortcuts . . . . .	32
wallpaper . . . . .	33
clock style . . . . .	33
date . . . . .	33
main menu appearance . . . . .	34
rearrange main menu . . . . .	34
<b>email</b> . . . . .	<b>35</b>
check your email account . . . . .	35
<b>accessories</b> . . . . .	<b>36</b>

# menu map







## main menu

-  **Contacts**
-  **Messages**
  - Create Message
  - Inbox
  - My Folders
  - Templates
  - Drafts
  - Outbox
  - Create Postcard \*
  - Email
  - Call Voicemail
-  **Office Tools**
  - Calendar
  - SYNC
  - Download Manager
  - **(continued next column)**
-  **Office Tools (cont.)**
  - File Manager
  - Memory Card
  - My Blog \*
  - Music and Sounds
  - Pictures
  - Videos
  - Voice Notes
  - Application Downloads
  - Unrecognizable Files
  - My Documents
  - Alarm Clock
  - World Clock
  - Calculator
  - SIM Applications \*
  - Dialing Services
  - Task List
  - Notes
  - Help

**(continued next page)**

\* optional features

## main menu (continued)

-  **Multimedia**
  - Media Finder
  - Games
  - Camera
  - Video Camera
  - Voice Recorder
-  **Help**
-  **Recent Calls**
-  **Web Access**
  - Browser
  - My Bookmarks
  - My Web Pages
  - History
  - Go to URL
  - Browser Setup
-  **Settings**
  - (see next page)
-  **Games**

This is the standard main menu layout. **Your phone's menu may be different.**

To change your home screen shortcuts and main menu appearance, see page 32.

**Tip:** Press  to change the main menu to a list view and back.

\* optional features

## settings menu

- **Profiles**
- **Themes**
- **Home Screen**
  - Icons
  - Wallpaper
  - Clock Style
  - Date
- **Connections**
  - Bluetooth®
  - USB Setting
    - Media Synchronization
    - Memory Card
    - Modem
    - USB Printing
    - Tools
    - Modem & Tools
  - Voice Networks
    - Voice Over IP
    - Network Settings
  - Data Connections
    - Add a Connection
    - Edit a Connection
    - Remove a Connection
- **Call Settings**
  - Speed Dial
  - Call Forward
  - In-Call Setup
    - Hearing Aid
    - My Caller ID
    - In-Call Timer
    - Answer Options
    - In-Call Message Alert
    - Roam Alert
    - Call Waiting
    - Auto-Redial
    - Call Drop Tone
  - Dialing Setup
    - My Caller ID
    - DTMF
    - Search Mode
    - Dialing Prefix
  - Fixed Dialing
  - My SIM Number
  - Active Line \*

**(continued next page)**

\* optional features

## settings menu (continued)

- **Phone Settings**
  - Display Settings
    - Display Timeout
    - Screensaver
    - Brightness
  - Airplane Mode
  - Battery Meter
  - Battery Save
  - Time & Date
  - Touch Sensor Sound
  - Language
  - Talking Phone
  - Text Entry
  - Reset
    - Reset All Settings
    - Delete All Data
    - Delete Memory Cards
  - View Memory
  - Properties
  - Java™ System
  - OTA Updates
  - Headset Settings
    - Auto-Answer
    - Voice Dial
  - TTY Settings
- **Security**
  - Phone Lock
  - External Key Lock
  - Application Lock
  - SIM Lock
  - Change Passwords
  - Certificates
  - Anti-Virus
- **Network**
  - Current Network
  - Scan Avail. Networks
  - Find New Network
  - My Network List
  - Search Setup
  - Service Tone

\* optional features

9

## get started

### insert your SIM card

Your *Subscriber Identity Module* (SIM) card stores your phone number and other information.

**Caution:** Don't bend or scratch your SIM card. Keep it away from static electricity, water, and dirt.

- 1 Press in the battery door release latch.
- 2 Slide up and remove the battery door.

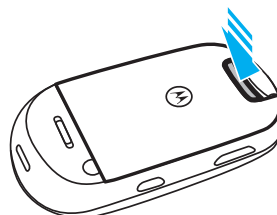

- 3 Slide the SIM card into the card slot.

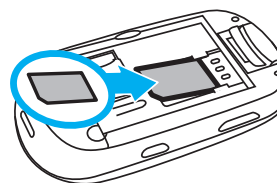

10

## get started

### insert a memory card

You can store music, photos, and other multimedia files on an optional removable microSD memory card. 

**Caution:** Don't bend or scratch your memory card. Keep it away from static electricity, water, and dirt. Turn off your phone before you install or remove the memory card.

**Note:** Your phone can use a memory card with up to 4 GB capacity (greater than 1 GB storage guaranteed only for SanDisk microSD cards).

#### To insert the memory card:

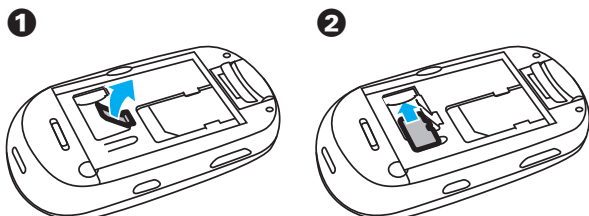

**To remove the memory card:** Lift up the flexible retainer tab, and slide the memory card out of the slot.

11

## get started

### insert the battery

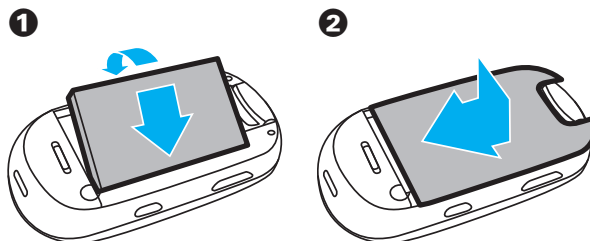

### charge the battery

New batteries are not fully charged. Open the protective cover on your phone's micro-USB port, and insert the battery charger connector into your phone. Make sure the Motorola

symbol on the battery charger connector is facing **up**, as shown in the illustration. Plug the other end of the battery charger into an electrical outlet.

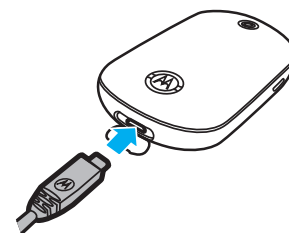

12

## get started













The battery charge indicator light on your phone shows when the battery is charging. The display shows **Charge Complete** when finished.

**Note:** For battery use and battery safety information, see your *User's Guide*.

13

## get started

### extend battery life

- To make your **display** turn off sooner, press  >  **Settings** > **Phone Settings** > **Display Settings** > **Display Timeout** > **5 Seconds**.
- To turn off the **screensaver** in the internal display, press  >  **Settings** > **Phone Settings** > **Display Settings** > **Screensaver** > **Off**.
- To turn off the **animated screensaver** in the external display, press  >  **Settings** > **Themes** press **Options** > **Edit**, press  right to select the **images** tab , press  down to scroll to **External Screensaver**, press  to select it, scroll to **None**, press  to select it.
- To turn off **Bluetooth®** power when you're not using it, press  >  **Settings** > **Connections** > **Bluetooth**, press **Options** > **Setup Bluetooth** > **Bluetooth Power** > **Off**.

14

## get started

### turn phone on & off

Press and hold the *power/end key*  for a few seconds, or until the display turns on or off.

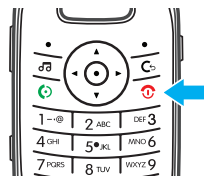

### make a call

Open the flip, then enter a phone number and press the *send key* .

**Tip:** To **voice dial** a call, see your *User's Guide*.

### answer a call

When your phone rings and/or vibrates, open the phone flip or press  to answer.

### end a call

To "hang up," close the phone flip or press .

15

## get started

### store a phone number

You can store a phone number in your list of **Contacts**.

**Note:** You can store a new contact in **phone memory**, or store the contact both in phone memory and on your **SIM card**. When you choose to store a contact to both locations, only the contact's name and phone number are stored on the SIM card.

To store a phone number:

- 1 Enter a phone number in the home screen.
- 2 Press **Save**.
- 3 Enter a name for the phone number, and enter other information as desired.
- 4 If you want to save the number on your SIM card in addition to storing it in phone memory, select **Save to SIM Card**.
- 5 Press **Save** to store the contact.

**Tip:** To learn more about storing phone numbers and email addresses on your phone, see your *User's Guide*.

16

## get started

### call a stored phone number

To call a number stored in your contact list:

**Find it:**  >  Contacts

❶ Scroll to the contact.

**Shortcut:** In the contact list, press keypad keys to enter the first letters of the contact you want.

Press  to go to the contact.

❷ Press  to call the contact.

**Note:** If you've got contacts stored on your SIM card, but the contacts aren't visible when you open the contact list, you need to copy the contacts into phone memory.

Press **Options** > **Import Contacts** > **SIM Card**, press **Options** > **Select All**, press **Import**.

17

## get started

### your phone number

To see your phone number:

**Find it:**  >  Settings > Call Settings > My SIM Number

To see your phone number while you're on a call, press **Options** > **My Tel. Numbers**.

To store or edit your name and phone number on your SIM card, select the field you want to edit. If you don't know your phone number, contact your service provider.

18

## music

### introduction

To listen to music on your phone, you need to:

- ❶ Load music on your computer.
- ❷ Transfer music from the computer to your phone.
- ❸ Use the music player to play and manage music files on your phone.

### 1. load music on your computer

To create a music library on your computer, you can purchase Microsoft® Windows® Media DRM-protected music files from supported on-line music stores (such as Urge, Yahoo, and Napster).

You can also **load song files from a music CD** onto your computer:

- ❶ Insert the music CD in your computer's CD drive.
- ❷ Launch Windows Media Player 11.

19

## music

- ❸ Copy the music CD to the media player library (also called *ripping* the CD).

If your computer is connected to the Internet, the media player may retrieve CD information such as song titles, album name, artist name, and album artwork. This information will display in your phone's music player.

To minimize song file size, or convert iTunes song files to a format compatible with Microsoft® Windows® Media Player 11, see your *User's Guide*.

### 2. transfer music to your phone

Use Windows Media Player 11 to transfer music from the computer to your phone. (If necessary, you can download Windows Media Player 11 at [www.microsoft.com/windowsmedia](http://www.microsoft.com/windowsmedia)).

**Note:** Windows Media Player 11 requires Windows XP™ or later to run. If you are using an earlier version of Windows OS, see your *User's Guide* to manually transfer music to your phone.



20

# music

**Note:** Windows Media Player 11 can copy and sync music files only to the memory card in your phone. To copy files to phone memory, see your *User's Guide* to manually transfer music to your phone.

**Note:** Windows Media Player 11 can only be used to copy music files to your phone. You can't use Windows Media Player 11 to copy pictures or videos to the phone.

## on your phone

Insert a memory card in your phone (see page 11), then press  >  **Settings** > **Connections** > **USB Setting** > **Media Synchronization**

Attach the Motorola Original USB cable to the micro-USB port on your phone and to an available USB port on your computer. A  Motorola Original USB cable and supporting software may be included with your phone. These tools are also sold separately.

**Note:** Some phone functions are temporarily unavailable when a USB connection is active.

21

# music

## on your computer

Run Windows Media Player 11. Your phone appears in the upper right corner of the Windows Media Player 11 screen, and the music files stored on the phone's memory card are listed on the left side of the screen.

- 1 Select the Sync tab in Windows Media Player 11.
- 2 Drag and drop songs or playlists onto the Sync List on the right side of the Windows Media Player 11 screen.
- 3 Click Start Sync to copy the songs onto the phone's memory card.
- 4 When you finish, disconnect your phone from the computer.

## 3. play music

To play music on your phone:

**Find it:**  > **category** > **song name**

Select a song or playlist from the following categories: **Recently Played**, **Shuffle Songs** (play all songs in random order), **All Songs**, **Playlists**, **Artists**, **Albums**, **Genres**, or **Composers**.

22

# music

**Note:** If you receive a call during a song, the song pauses until the call is over.

When a song or playlist starts to play, close the phone flip and use the touch keys to control song playback in the external display.

**Tip:** For best results, use the flat part of your finger to activate the touch key controls.

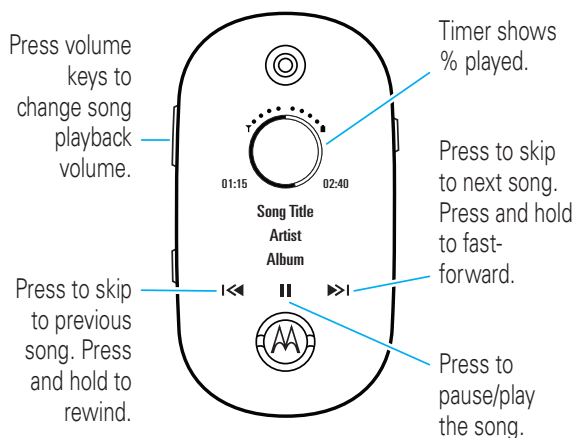

23

# music

**Note:** To control song playback when the phone flip is open, see your *User's Guide*.

## use Bluetooth® stereo headphones

Connect your phone with optional Bluetooth stereo headphones to listen to music stored on your phone. 

**To connect your phone to a set of Bluetooth stereo headphones for the first time**, make sure the headphones are **on** and **ready** in *pairing* or *bonding* mode (see the device user's guide).

**Find it:**  >  **Settings** > **Connections** > **Bluetooth**, press **Options** > **Search For Device** > **Headset**

Your phone lists the Bluetooth audio devices it finds within range.

- 1 Scroll to the stereo headphones in the list.
- 2 Press  to connect with the stereo headphones.

24

## adjust audio settings

You can adjust audio settings to optimize the sound quality when listening to music through the phone speaker, stereo headphones, or headset.

To change **playback volume**, press the volume keys on the side of your phone.

To change the **equalizer setting**, press **Options** > **Setup** > **Equalizer** > *music type*.

To set **stereo separation**, press **Options** > **Setup** > **Stereo Effects** > **Spatial Audio** > *separation level*.

To set **bass boost**, press **Options** > **Setup** > **Stereo Effects** > **Bass Boost** > *bass level*.

## lock external phone keys

You can lock the external phone keys and touch keys when the phone flip is closed, to prevent accidental keypresses while playing a song or playlist.

To **manually lock** the external keys: Close the phone flip, then press and hold the side select key. The keys remain locked until you open the phone flip.

25

To **automatically lock** the external keys, see your *User's Guide*.

## create a playlist

### create a playlist on your computer

Use Windows Media Player 11 to create a playlist of music files stored on the computer.

On your phone, press  >  **Settings** > **Connections** > **USB Setting** > **Memory Card**.



Connect your phone to the computer through a USB cable connection, then drag and drop the playlist onto the phone or memory card.

### create a playlist on your phone

**Find it:**  > **Playlists**, press **Options** > **Create New Playlist**

- 1 Enter a name for the playlist.
- 2 Select a storage location for the playlist (**Memory Card** or **Phone Memory**), then press **Save**.
- 3 Scroll to the playlist you created, and press  to select it.

26

- 4 Scroll to **Add Songs**, and press  to select it.
- 5 Scroll to **All Songs**, **Artists**, **Albums**, **Genres**, or **Composers**, and press  to select it.
- 6 Scroll to the songs you want to add, and press  to select them.
- 7 Press **Add** to add the selected songs to the playlist.
- 8 Repeat the procedure to add more songs, or press **Back** to return to the **Playlists** menu.

## play a playlist

**Find it:**  > **Playlists**, scroll to the playlist, press **Options** > **Play**

## close the music player





From the music player screen or home screen, press  to close the music player.

27

## show animated screensavers in the external display

Personalize your phone with floating animated screensavers in the external display:

**Find it:**  >  **Settings** > **Themes** press **Options** > **Edit**

- 1 Press  right to select the **images** tab .
- 2 Press  down to scroll to **External Screensaver**, then press .
- 3 Press  up/down to scroll to an animated screensaver.
 

**Tip:** Press  to preview the highlighted screensaver before you select it.
- 4 Press **Select** to select the highlighted screensaver.
- 5 Press **Save** to save your setting.

The **External Screensaver** appears in the external display when you close the phone flip.

28

## screensavers

**Note:** Changing the animated screensaver does **not** change the background image behind the clock in the external display.

### shortcuts to themes

To quickly go to themes from the home screen, press **Options > Change Theme**.

Alternatively, you can create a shortcut in the home screen that takes you directly to themes. To create a home screen shortcut, see page 32.

29

## messages

### read & reply to a message in the external display

When the phone flip is closed and you receive a message, your phone plays an alert, and the external display shows **New Message from X**, where **X** is the sender's number or name.



To read and reply to the message in the external display:

- 1 Press the volume keys on the side of your phone to scroll to **View**, then press the side select key to read the message.
- 2 When you finish reading the message, press the side select key to close it.
- 3 To answer the message, press the volume keys to scroll to **Quick Reply**, then press the side select key.
- 4 Press the volume keys to scroll to a pre-written *quick note* message, then press the side select key to select it.

**Tip:** Your phone stores a variety of pre-written quick notes, and you can create and store additional

30

## messages

quick notes. For more information, see your *User's Guide*.

- 5 Press the volume keys on the side of your phone to scroll to **Send**, then press the side select key to send your reply.

To learn more about sending and receiving messages with your phone, see your *User's Guide*.

### send a message

To send a message to a compatible phone or to an email address:



**Find it:**  >  **Messages > Create Message**

To learn more about sending and receiving messages with your phone, see your *User's Guide*.

31

## personalize

### home screen shortcuts

From the home screen, you can press the navigation key up, down, left, or right as shortcuts to your favorite features. You can change the shortcuts to suit your needs.



To **change** navigation key shortcut icons in the home screen:

**Find it:**  >  **Settings > Home Screen > Icons > Up, Down, Left, or Right**

Select a direction, then choose the feature you want to open when you press the navigation key in that direction.

To **show or hide** navigation key shortcut icons in the home screen:

**Find it:**  >  **Settings > Home Screen > Icons > Icon Display > Show or Hide**

**Note:** You can press  to select the features in the home screen even when the icons are hidden.

32

# personalize

## wallpaper

Change the background wallpaper image in the home screen:

**Find it:**  >  **Settings** > **Home Screen** > **Wallpaper**, scroll to an image, press **Select**

The new wallpaper is applied to the current theme.

## clock style

Change the clock style in the home screen, or turn off the clock:

**Find it:**  >  **Settings** > **Home Screen** > **Clock Style** > **Home Screen Clock**

## date

Show or turn off the date in the home screen:

**Find it:**  >  **Settings** > **Home Screen** > **Date** > **On** or **Off**

33

# personalize

## main menu appearance

You can personalize the main menu to appear as a grid of graphic icons, a text-based list, or a set of spinning menu icons that you can scroll through:

**Find it:** From the main menu, press **Options** > **View By** > **Grid** or **List** or **Spinner**

## rearrange main menu

You can change the order of the main menu features.

From the main menu, press **Options** > **Reorder**, scroll to the feature you want to move, press **Grab**, scroll to the destination location, press **Insert**.

34

# email

## check your email account

Check your personal Web-based **email** account (such as Hotmail, Gmail, or Yahoo).



**Note:** You must have browser service activated on your phone to use this feature.

**Find it:**  >  **Web Access** > **Browser**

- 1 Press **Options** > **Go to URL**.
- 2 Enter the URL for your Web-based email account, then press **Go**.

To learn more about using the phone browser, see your *User's Guide*.

35

# accessories



Bluetooth® Stereo Headphones S9



Bluetooth® Stereo Headphones HT820



Bluetooth® Slider Headset H800



Bluetooth® Headset H670



Bluetooth® Stereo Controller S705



Bluetooth® Headset H700

To see more accessories, visit [www.hellomoto.com](http://www.hellomoto.com)

36

[www.hellomoto.com](http://www.hellomoto.com)

Certain mobile phone features are dependent on the capabilities and settings of your service provider's network. Additionally, certain features may not be activated by your service provider, and/or the provider's network settings may limit the feature's functionality. Always contact your service provider about feature availability and functionality. All features, functionality, and other product specifications, as well as the information contained in this user's guide are based upon the latest available information and are believed to be accurate at the time of printing. Motorola reserves the right to change or modify any information or specifications without notice or obligation.

MOTOROLA and the Stylized M Logo are registered in the US Patent & Trademark Office. The Bluetooth trademarks are owned by their proprietor and used by Motorola, Inc. under license. Microsoft and Windows are registered trademarks of Microsoft Corporation; and Windows XP and Windows Media are trademarks of Microsoft Corporation. Macintosh is a registered trademark of Apple Computer, Inc. All other product or service names are the property of their respective owners.

© Motorola, Inc. 2008. All rights reserved.

**Caution:** Changes or modifications made in the radio phone, not expressly approved by Motorola, will void the user's authority to operate the equipment.

Manual Number: 68000201413-A

[www.motorola.com](http://www.motorola.com)

